

FÁBRICA DE CONTERAS DE PLÁSTICO 2019



FOR  APS



ORTAPS

FORTAPS

FORTAPS es una empresa familiar constituída el año 1996 y respaldada por la experiencia de dos generaciones dedicadas al ámbito de su especialidad.

Su actividad se centra en el diseño, fabricación y comercialización de protectores de plástico: conteras, tapafinales y topes, adoptando para ello los estándares de gestión de calidad ISO 9001:2015.

FORTAPS dispone de más de 7.000m² estructurados para optimizar el proceso de recepción de pedidos, fabricación, stock y expedición de mercancías en las mejores condiciones de calidad y celeridad.

ISO 9001

BUREAU VERITAS
Certification



ISO 9001:2015 N° ES088967-1

ÍNDICE CONTERAS

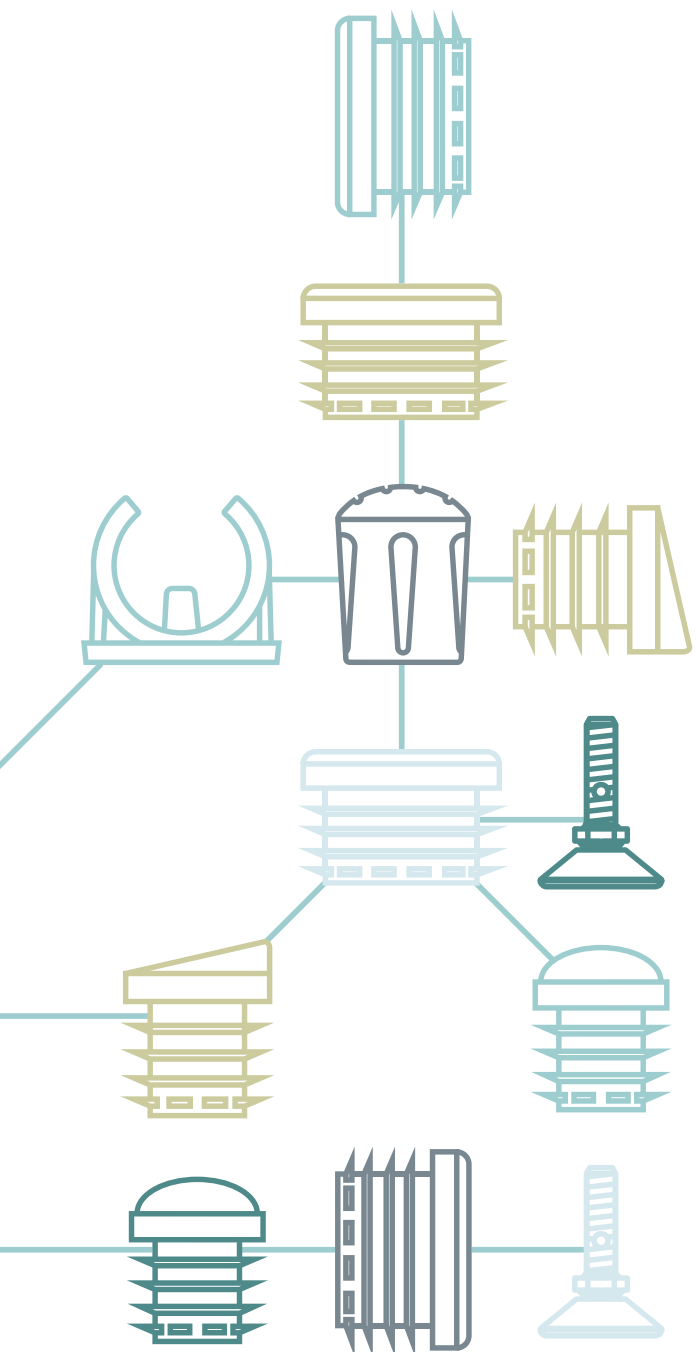

Descarga del catálogo en PDF

REDONDAS

- 6

Ref. 16
Contera redonda interior estriada
- 6

Ref. 17
Tapafinal redondo interior estriado
- 7

Ref. 20
Contera redonda interior estriada plana
- 7

Ref. 29
Tapafinal redondo interior estriado acabado en cromo brillo o cromo mate
- 8

Ref. 30
Contera reforzada redonda interior estriada
- 8

Ref. 36
Contera semiesférica antideslizante ligera
- 8

Ref. 37
Tapafinal redondo interior estriado cabeza semiesférica
- 9

Ref. 46
Tapafinal redondo interior estriado acabado brillo
- 9

Ref. 52
Contera redonda reforzada antideslizante

RECTANGULARES

- 10

Ref. 19
Contera rectangular interior estriada
- 11

Ref. 27
Tapafinal rectangular interior estriado

OVALES

- 12

Ref. 18
Contera rectangular ovalada interior estriada
- 12

Ref. 23
Tapafinal ovalado interior estriado

CUADRADAS

- 

12 **Ref. 24**
Tapafinal cuadrado interior estriado
- 

13 **Ref. 15**
Contera cuadrada interior estriada
- 

13 **Ref. 26**
Contera cuadrada interior estriada para tubos estructurales
- 

14 **Ref. 31**
Contera cuadrada inclinada interior estriada
- 

14 **Ref. 31 camas**
Contera cuadrada inclinada interior estriada
- 

15 **Ref. 44**
Tapafinal cuadrado interior estriado acabado en cromo brillo
- 

15 **Ref. 47**
Tapafinal cuadrado interior estriado acabado brillo

PIES NIVELADORES

- 

16 **Ref. 34**
Contera cuadrada interior roscada
- 

16 **Ref. 35**
Contera redonda interior roscada
- 

17 **Ref. 56**
Contera interior roscada
- 

18 **Ref. 53**
Base con rótula
- 

18 **Ref. 55**
Pie nivelador con rótula
- 

18 **Ref. 58**
Pie nivelador de perfil bajo
- 

19 **Ref. 45**
Pie nivelador

EXTERIORES

- 

20 **Ref. 50**
Contera redonda exterior reforzada
- 

20 **Ref. 40**
Contera redonda exterior flexible
- 

21 **Ref. 41**
Contera redonda exterior
- 

21 **Ref. 41**
Contera cuadrada exterior
- 

21 **Ref. 41**
Contera rectangular exterior
- 

22 **Ref. 43**
Contera redonda exterior para bastones con arandela metálica, caucho vulcanizado

ESPECIALES

- 

21 **Ref. 48**
Tapatuerca
- 

22 **Gama complementaria**
- 

23 **Ref. 59**
Pie de media caña para tubo horizontal
- 

23 **Ref. 60**
Tope atornillable
- 

23 **Ref. 57**
Contera para tubo horizontal (Brida)
- 

24 **Ref. 32**
Topes tipo chincheta
- 

24 **Ref. 33**
Topes tipo chincheta para tubos redondos
- 

24 **Ref. 10**
Tope redondo semiesférico

FABRICANTES DESDE 1996

FABRICACIÓN

El control de nuestra calidad nos obliga a realizar nuestros propios moldes con aceros calibrados y las últimas tecnologías en mecanización computerizada.

La inyección de las piezas se realiza en PEL (Polietileno de baja densidad), excepto las bridas y los roscados que, al requerir una mayor dureza, se fabrican en PEHD (Polietileno de alta densidad); los cromados se fabrican en ABS y los antideslizantes en caucho termoplástico. Descartamos el uso del PVC por motivos obvios medioambientales y de reciclaje.

La superficie exterior de las piezas (excepto en los cromados) posee un acabado "mate", esto es erosionado. En el interior de ellas, para facilitar su identificación, se ha marcado el diámetro exacto o el intervalo de tubo al que se adaptan.

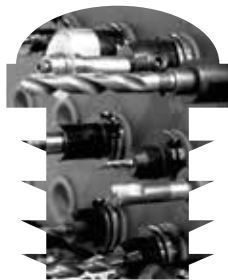
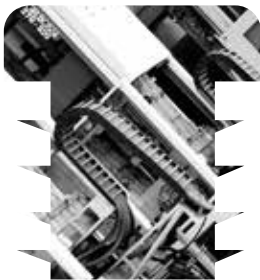

ACABADOS

Utilizamos básicamente los colores blanco o negro, aunque, también podemos inyectar piezas en otros colores basados en la gama RAL.

Los estándares en nuestro sistema de producción establecen la trazabilidad de todos nuestros lotes, permitiendo detectar cualquier incidencia, si la hubiese, y subsanarla de forma óptima.

Producción ecológica:

Hemos querido incorporar el concepto, para nosotros imprescindible, de producción respetuosa con el medio ambiente. Para ello actuamos con tres premisas: producción con maquinaria de última generación que reduce al máximo el consumo de energía; materia prima no tóxica (Polietileno); reciclaje propio de todos los restos de material.

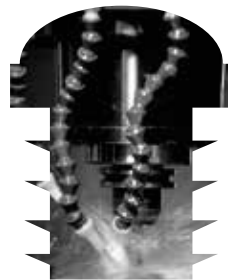

DISEÑO

Nuestro proceso de producción se inicia con el diseño de las piezas:

Las aletas exteriores permiten que la pieza se adapte a los diferentes espesores de tubo. La aleta partida es la de menor diámetro y sirve para posicionar la pieza y permitir su colocación con una ligera presión.

Las estrías recorren el interior de la pieza, acentúan su flexibilidad y mejoran el centraje de la misma.

Los nervios interiores incorporados en las piezas grandes, aseguran la presión sobre el tubo, evitando que sea fácilmente extraíble.

Además de nuestras referencias, que cubren la mayoría de las necesidades en cuanto a medidas y formatos, podemos realizar, bajo demanda, nuevas referencias que se ajusten a sus requerimientos.

FORTAPS SL se reserva el derecho de efectuar cualquier tipo de modificación o eliminación de sus productos, no aceptando ninguna responsabilidad al respecto.

STOCK, SERVICIO DE VENTA Y DISTRIBUCIÓN

Cualquier proceso de fabricación de un producto tiene como fin intrínseco la venta y distribución del mismo, y es aquí donde reside el otro componente importante del éxito.

Un pedido inicia un proceso ininterrumpido que finaliza cuando nuestro cliente recibe la mercancía solicitada. Para que esto suceda sin dilaciones, mantenemos stock permanente de todas nuestras referencias, permitiéndonos servir a nuestros clientes, si así lo desean, en un plazo de 24h (los pedidos recibidos antes de las 15.00h, son expedidos el mismo día).

El control pormenorizado de la situación de las mercancías en el proceso de transporte, nos permite poder facilitar información en todo momento sobre el paradero de las expediciones, evitar extravíos, notificar posibles retrasos, etc.

NUESTROS COMPROMISOS



800 referencias estándar
Fabricación en RAL bajo pedido
Soluciones a medida



10,5 millones de piezas en stock
Todo pedido recibido antes de las 15:00 h
es expedido el mismo día
Entrega en 24/48 horas



Atención al cliente
comercial@fortaps.com
departamento.tecnico@fortaps.com
902.364.083



ISO 9001:2015 N° ES088967-1

Fabricación y comercialización:
Gestión de calidad certificada.
Norma ISO 9001:2015

NUESTRO SITIO INTERNET



www.fortaps.com
Todos nuestros productos y novedades
Detalles y planos 3D, .igs y fichas de producto
Solicitud de muestras y presupuestos
Códigos EAN de todas nuestras referencias

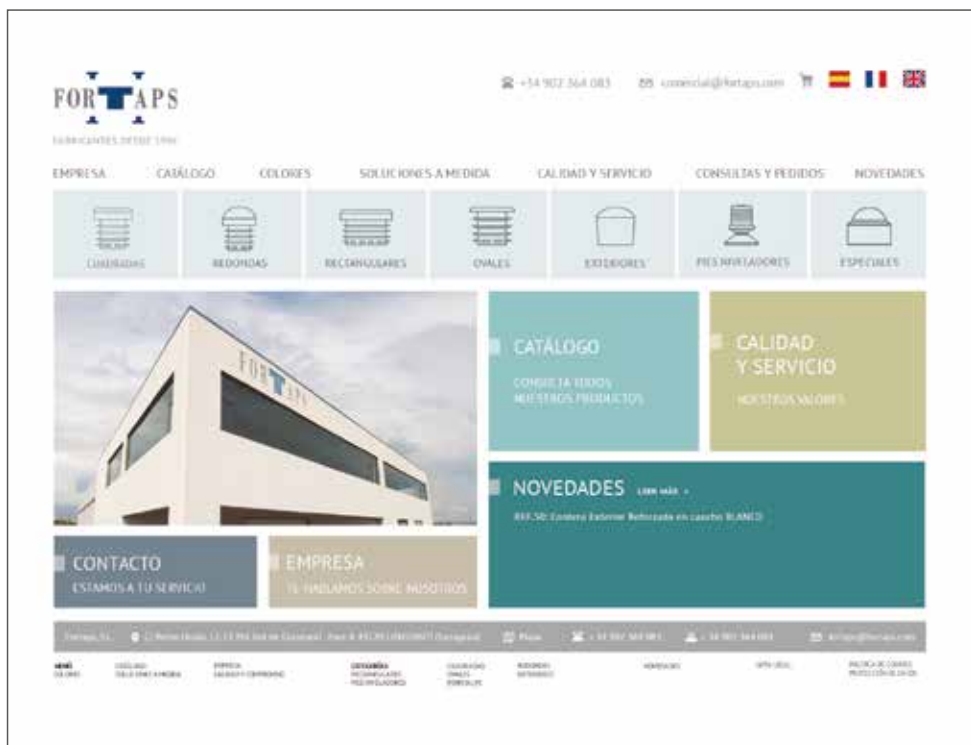

Ref. 16

Contera redonda interior estriada

Polietileno baja densidad
blanco o negro

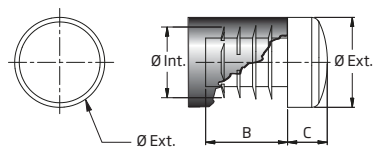

| REFERENCIA | Ø Ext. | Ø Int. | B | C | GROSOR TUBO | ENVASES |
|------------|--------|-----------|------|------|-------------|---------|
| 16 - 12 | 12 | 8 a 10 | 12,0 | 5,5 | 1,0 a 2,0 | 1000 |
| 16 - 14 | 14 | 10 a 12 | 12,0 | 5,5 | 1,0 a 2,0 | 1000 |
| 16 - 16/1 | 16 | 13,2 a 14 | 15,5 | 6,5 | 1,0 a 1,4 | 500 |
| 16 - 16/2 | 16 | 12 a 13 | 15,5 | 6,5 | 1,5 a 2,0 | 500 |
| 16 - 16/3 | 16 | 11 a 13 | 15,5 | 6,5 | 1,25 a 2,5 | 500 |
| 16 - 18 | 18 | 14 a 16 | 16,5 | 8,0 | 1,0 a 2,0 | 1000 |
| 16 - 20 | 20 | 16 a 18 | 18,5 | 10,0 | 1,0 a 2,0 | 500 |
| 16 - 21 | 21 | 17 a 19 | 18,5 | 10,0 | 1,0 a 2,0 | 500 |
| 16 - 22 | 22 | 18 a 20 | 17,5 | 10,0 | 1,0 a 2,0 | 500 |
| 16 - 23 | 23 | 19 a 21 | 17,5 | 10,0 | 1,0 a 2,0 | 500 |
| 16 - 25 | 25 | 21 a 23 | 18,5 | 9,0 | 1,0 a 2,0 | 500 |
| * 16 - 25 | 27,5 | 18 a 20,5 | 18,0 | 9,0 | 2,5 a 3,5 | 500 |
| 16 - 26 | 26 | 22 a 24 | 18,0 | 9,0 | 1,0 a 2,0 | 500 |
| 16 - 28 | 28 | 24 a 26 | 20,0 | 8,5 | 1,0 a 2,0 | 500 |
| 16 - 30 | 30 | 26 a 28 | 18,5 | 10,0 | 1,0 a 2,0 | 200 |

* Cabeza sobredimensionada para apilar

Ref. 17

Tapafinal redondo interior estriado

Polietileno baja densidad
blanco o negro
Hasta Ø30, disponible en
gris RAL 7040

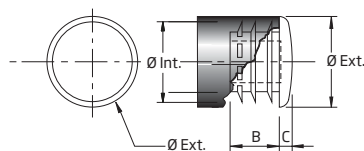

| REFERENCIA | Ø Ext. | Ø Int. | B | C | GROSOR TUBO | ENVASES |
|------------|--------|-----------|------|-----|-------------|---------|
| 17 - 10 | 10 | 5,5 a 8,0 | 7,0 | 1,0 | 1,0 a 2,25 | 2500 |
| 17 - 12 | 12 | 7,5 a 10 | 7,5 | 1,5 | 1,0 a 2,25 | 2500 |
| 17 - 14 | 14 | 9,5 a 12 | 7,3 | 1,7 | 1,0 a 2,25 | 2500 |
| 17 - 16 | 16 | 11,5 a 14 | 9,0 | 2,0 | 1,0 a 2,25 | 1000 |
| 17 - 18 | 18 | 13 a 16 | 7,5 | 3,0 | 1,0 a 2,5 | 1000 |
| 17 - 20 | 20 | 15 a 18 | 9,0 | 3,0 | 1,0 a 2,5 | 1000 |
| 17 - 22 | 22 | 17 a 20 | 9,5 | 3,0 | 1,0 a 2,5 | 1000 |
| 17 - 25 | 25 | 20 a 23 | 9,0 | 3,5 | 1,0 a 2,5 | 500 |
| 17 - 28 | 28 | 23 a 26 | 9,5 | 3,5 | 1,0 a 2,5 | 500 |
| 17 - 30 | 30 | 25 a 28 | 9,5 | 3,5 | 1,0 a 2,5 | 500 |
| 17 - 32 | 32 | 27 a 30 | 10,9 | 3,6 | 1,0 a 2,5 | 500 |
| 17 - 35 | 35 | 30 a 33 | 10,0 | 4,5 | 1,0 a 2,5 | 500 |
| 17 - 38 | 38 | 30 a 33 | 7,5 | 3,0 | 2,5 a 4,0 | 500 |
| 17 - 40 | 40 | 35 a 38 | 13,0 | 5,0 | 1,0 a 2,5 | 200 |
| 17 - 45 | 45 | 40 a 43 | 13,5 | 5,5 | 1,0 a 2,5 | 200 |
| 17 - 50 | 50 | 45 a 48 | 11,7 | 3,8 | 1,0 a 2,5 | 100 |
| 17 - 60 | 60 | 54,5 a 58 | 11,7 | 4,4 | 1,0 a 2,75 | 100 |

Ref. 20

Contera redonda interior estriada plana

Polietileno baja densidad
blanco o negro

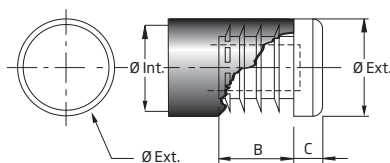

| REFERENCIA | Ø Ext. | Ø Int. | B | C | GROSOR TUBO | ENVASES |
|------------------------|--------------|-------------|------|------|-------------|---------|
| 20 - 27 | 27 | 21 a 25 | 19,0 | 6,5 | 1,0 a 3,0 | 200 |
| 20 - 30 | 30 | 26 a 28 | 19,5 | 6,0 | 1,0 a 2,0 | 200 |
| 20 - 32 | 32 | 28 a 30 | 19,5 | 6,0 | 1,0 a 2,0 | 200 |
| 20 - 35 | 35 | 31 a 33 | 18,0 | 7,0 | 1,0 a 2,0 | 200 |
| 20 - 38 | 38 | 32 a 36 | 19,0 | 6,5 | 1,0 a 3,0 | 200 |
| 20 - 40 | 40 | 35 a 38 | 18,0 | 7,0 | 1,0 a 2,5 | 100 |
| 20 - 42 | 42 | 36,5 a 40 | 19,0 | 6,0 | 1,0 a 2,75 | 100 |
| 20 - 45 | 45 | 40 a 43 | 18,5 | 6,5 | 1,0 a 2,5 | 100 |
| 20 - 48 | 48 | 42,5 a 46 | 19,0 | 6,0 | 1,0 a 2,75 | 100 |
| 20 - 50 | 50 | 44,5 a 48 | 18,5 | 5,5 | 1,0 a 2,75 | 100 |
| 20 - 50 (2,5 a 5,0) | 50 | 40 a 45 | 18,0 | 5,75 | 2,6 a 5,0 | 100 |
| 20 - 55 | 55 | 49,5 a 53 | 19,0 | 6,0 | 1,0 a 2,75 | 100 |
| 20 - 57,2 | 57,2 (2"1/4) | 50,2 a 55,2 | 19,9 | 6,3 | 1,0 a 3,5 | 100 |
| 20 - 60 | 60 | 55 a 58 | 17,0 | 8,0 | 1,0 a 2,5 | 100 |
| 20 - 60 (2,5 a 5,0) | 60 | 50 a 54,8 | 19,5 | 6,5 | 2,6 a 5,0 | 100 |
| 20 - 63 | 63 | 58 a 61 | 19,0 | 5,5 | 1,0 a 2,5 | 50 |
| 20 - 70 | 70 | 64 a 68 | 18,5 | 6,5 | 1,0 a 3,0 | 50 |
| 20 - 76 | 76 | 70,5 a 74 | 19,5 | 5,5 | 1,0 a 2,75 | 50 |
| 20 - 76 (3,0 a 4,5) | 76 | 67 a 70 | 19,5 | 5,5 | 3,0 a 4,5 | 50 |
| 20 - 80 | 80 | 73 a 78 | 18,5 | 6,5 | 1,0 a 3,5 | 50 |
| 20 - 85 | 85 | 77 a 82 | 21 | 6,5 | 1,5 a 4,0 | 50 |
| 20 - 90 | 90 | 83 a 88 | 17,0 | 5,0 | 1,0 a 3,5 | 25 |
| 20 - 100 (1,0 a 2,0) | 100 | 96 a 98 | 17,0 | 5,0 | 1,0 a 2,0 | 25 |
| 20 - 100 (2,25 a 3,75) | 100 | 92,5 a 95,5 | 17,0 | 5,0 | 2,25 a 3,75 | 25 |
| 20 - 100 (4 a 5) | 100 | 90 a 92 | 17,0 | 5,0 | 4,0 a 5,0 | 25 |
| 20 - 102 (1,5 a 2,5) | 102 | 97,5 a 99 | 17,0 | 5,0 | 1,5 a 2,25 | 25 |
| 20 - 102 (2,5 a 3,5) | 102 | 95 a 97 | 17,0 | 5,0 | 2,5 a 3,5 | 25 |
| 20 - 110 | 110 | 102 a 106 | 21,0 | 6,0 | 2,0 a 4,0 | 10 |
| 20 - 114 | 114 | 106 a 110 | 20,0 | 6,0 | 2,0 a 4,0 | 10 |
| 20 - 120 | 120 | 112 a 116 | 20,5 | 6,0 | 2,0 a 4,0 | 10 |

Ref. 29

Tapafinal redondo interior estriado acabado en cromo brillo Cromo mate bajo pedido

Material ABS

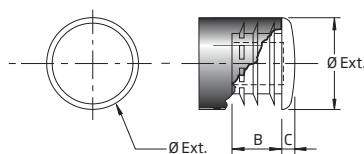

| REFERENCIA | Ø Ext. | B | C | GROSOR TUBO | ENVASES |
|------------|--------|------|-----|-------------------|---------|
| 29 - 18 | 18 | 8 | 4 | 1,0 | 500 |
| 29 - 20 | 20 | 9 | 2 | 0,8; 1,0; 1,5 y 2 | 500 |
| 29 - 22 | 22 | 10 | 2 | 1,0; 1,5 y 2,0 | 500 |
| 29 - 25 | 25 | 9 | 2 | 1,0; 1,5 y 2,0 | 500 |
| 29 - 28 | 28 | 9 | 3 | 1,5 | 500 |
| 29 - 30 | 30 | 9 | 3 | 1,0; 1,5 y 2,0 | 500 |
| 29 - 32 | 32 | 9 | 3 | 1,0 y 1,5 | 400 |
| 29 - 35 | 35 | 9 | 3 | 1,0; 1,5 y 2,0 | 350 |
| 29 - 40 | 40 | 10,5 | 4 | 1,0; 1,5 y 2,0 | 200 |
| 29 - 50 | 50 | 10,5 | 4,5 | 1,0; 1,5 y 2,0 | 100 |

Ref. 30

Contera reforzada redonda interior estriada

Polietileno baja densidad
blanco o negro

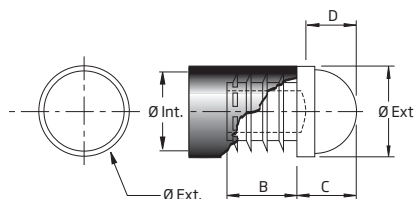

| REFERENCIA | Ø Ext. | Ø Int. | B | C | D | GROSOR TUBO | ENVASES |
|------------|--------|---------|----|----|----|-------------|---------|
| 30 - 18 | 18 | 12 a 16 | 18 | 13 | 10 | 1,0 a 2,0 | 500 |
| 30 - 20 | 20 | 16 a 18 | 18 | 14 | 11 | 1,0 a 2,0 | 500 |
| 30 - 22 | 22 | 18 a 20 | 18 | 15 | 12 | 1,0 a 2,0 | 500 |
| 30 - 25 | 25 | 21 a 23 | 18 | 16 | 14 | 1,0 a 2,0 | 500 |
| 30 - 30 | 30 | 26 a 28 | 20 | 17 | 16 | 1,0 a 2,0 | 200 |

Ref. 36

Contera semiesférica antideslizante ligera

Material antideslizante
"goma", negro o gris

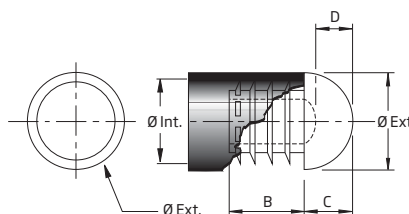

| REFERENCIA | Ø Ext. | Ø Int. | B | C | D | GROSOR TUBO | ENVASES |
|------------|--------|---------|----|------|------|-------------|---------|
| 36 - 18 | 18 | 14 a 16 | 24 | 9 | 11 | 1,0 a 2,0 | 500 |
| 36 - 20 | 20 | 16 a 18 | 24 | 10 | 11 | 1,0 a 2,0 | 500 |
| 36 - 22 | 22 | 18 a 20 | 24 | 11 | 11 | 1,0 a 2,0 | 500 |
| 36 - 25 | 25 | 21 a 23 | 24 | 12,5 | 14,5 | 1,0 a 2,0 | 500 |
| 36 - 30 | 30 | 26 a 28 | 24 | 15 | 16,5 | 1,0 a 2,0 | 200 |

Ref. 37

Tapafinal redondo interior estriado cabeza semiesférica

Polietileno baja densidad
blanco o negro

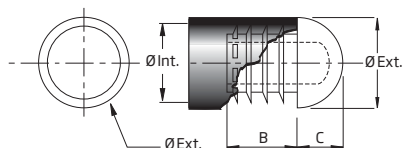

| REFERENCIA | Ø Ext. | Ø Int. | B | C | GROSOR TUBO | ENVASES |
|----------------------|--------|------------|----|------|-------------|---------|
| 37 - 18 | 18 | 14 a 16 | 24 | 9 | 1,0 a 2,0 | 500 |
| 37 - 20 | 20 | 16 a 18 | 24 | 10 | 1,0 a 2,0 | 500 |
| 37 - 22 | 22 | 18 a 20 | 24 | 11 | 1,0 a 2,0 | 500 |
| 37 - 25 | 25 | 21 a 23 | 24 | 12,5 | 1,0 a 2,0 | 500 |
| 37 - 30 | 30 | 26 a 28 | 24 | 15 | 1,0 a 2,0 | 200 |
| 37 - 35 | 35 | 31 a 33 | 24 | 17,5 | 1,0 a 2,0 | 200 |
| 37 - 40 | 40 | 36 a 38 | 24 | 20 | 1,0 a 2,0 | 100 |
| 37 - 50 | 50 | 46 a 48 | 24 | 25 | 1,0 a 2,0 | 50 |
| 37 - 60 | 60 | 56 a 58 | 24 | 30 | 1,0 a 2,0 | 50 |
| 37 - 80 | 80 | 74 a 78 | 19 | 23 | 1,0 a 3,0 | 25 |
| 37 - 80 (3,25 a 5,0) | 80 | 70 a 73,50 | 19 | 23 | 3,25 a 5,0 | 25 |

Ref. 46

Tapafinal redondo interior estriado acabado en brillo

Material ABS

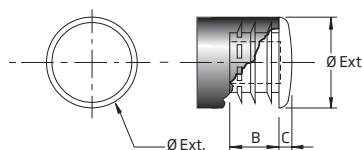

| REFERENCIA | Ø Ext. | B | C | GROSOR TUBO | ENVASES |
|------------|--------|------|-----|----------------|---------|
| 46 - 40 | 40 | 10,5 | 4 | 1,0; 1,5 y 2,0 | * |
| 46 - 50 | 50 | 10,5 | 4,5 | 1,0; 1,5 y 2,0 | * |

* Consultar

consultar la disponibilidad de colores



Ref. 52

Contera redonda reforzada antideslizante

Material caucho vulcanizado
Resistencia 75 kg por pie
Especial mobiliario para colectividades

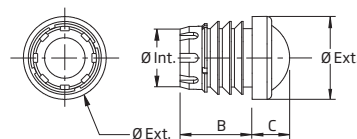

| REFERENCIA | Ø Ext. | Ø Int. | B | C | GROSOR TUBO | ENVASES |
|------------|--------|---------|----|----|-------------|---------|
| 52 - 18 | 20 | 15 a 16 | 22 | 10 | 1,0 a 1,5 | 500 |
| 52 - 20 | 22 | 17 a 18 | 22 | 12 | 1,0 a 1,5 | 500 |
| 52 - 22 | 24 | 19 a 20 | 23 | 12 | 1,0 a 1,5 | 500 |
| 52 - 25 | 27 | 22 a 23 | 23 | 12 | 1,0 a 1,5 | 500 |
| 52 - 30 | 32 | 27 a 28 | 24 | 12 | 1,0 a 1,5 | 200 |
| 52 - 35 | 37 | 32 a 33 | 26 | 13 | 1,0 a 1,5 | 100 |
| 52 - 40 | 42 | 37 a 38 | 26 | 14 | 1,0 a 1,5 | 100 |



Atención al cliente
comercial@fortaps.com
departamento.tecnico@fortaps.com
902.364.083

Ref. 19

Contera rectangular interior estriada

Polietileno baja densidad
blanco o negro

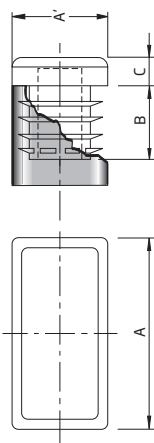

| REFERENCIA | A x A' | B | C | GROSOR TUBO | ENVASES |
|--------------------------|-----------|-------|------|-------------|---------|
| 19 - 20 x 10 | 20 x 10 | 10 | 5,0 | 1,0 a 2,5 | 500 |
| 19 - 20 x 15 | 20 x 15 | 15 | 6,0 | 1,0 a 3,0 | 500 |
| 19 - 25 x 10 | 25 x 10 | 17 | 5,0 | 1,0 a 2,5 | 500 |
| 19 - 25 x 15 | 25 x 15 | 10 | 5,0 | 1,0 a 2,5 | 500 |
| 19 - 30 x 10 | 30 x 10 | 14 | 5,0 | 1,0 a 2,5 | 500 |
| 19 - 30 x 15 | 30 x 15 | 15 | 6,0 | 1,0 a 2,5 | 500 |
| 19 - 30 x 20 | 30 x 20 | 15 | 6,0 | 1,0 a 2,5 | 500 |
| 19 - 30 x 25 | 30 x 25 | 20 | 6,0 | 1,0 a 2,5 | 250 |
| 19 - 35 x 15 | 35 x 15 | 17 | 5,0 | 1,0 a 2,5 | 500 |
| 19 - 35 x 20 | 35 x 20 | 17 | 5,0 | 1,0 a 2,5 | 200 |
| 19 - 35 x 25 | 35 x 25 | 17 | 5,0 | 1,0 a 3,0 | 200 |
| 19 - 40 x 10 | 40 x 10 | 17 | 5,0 | 1,0 a 2,5 | 500 |
| 19 - 40 x 15 | 40 x 15 | 10 | 5,0 | 1,0 a 2,5 | 500 |
| 19 - 40 x 20 | 40 x 20 | 16,5 | 6,0 | 1,0 a 3,0 | 200 |
| 19 - 40 x 25 | 40 x 25 | 17 | 5,0 | 1,0 a 3,0 | 250 |
| 19 - 40 x 27 | 40 x 27 | 17,0 | 6,0 | 1,0 a 3,0 | 200 |
| 19 - 40 x 30 | 40 x 30 | 14 | 7,0 | 1,0 a 2,75 | 200 |
| 19 - 45 x 25 | 45 x 25 | 17 | 5,0 | 1,0 a 2,5 | 100 |
| 19 - 45 x 35 | 45 x 35 | 20 | 5,5 | 1,0 a 3,5 | 100 |
| 19 - 50 x 10 | 50 x 10 | 10,5 | 3,7 | 1,0 a 2,0 | 500 |
| 19 - 50 x 15 | 50 x 15 | 15,5 | 5,0 | 1,0 a 3,0 | 500 |
| 19 - 50 x 20 | 50 x 20 | 14 | 7,0 | 1,0 a 3,0 | 250 |
| 19 - 50 x 25 | 50 x 25 | 14 | 7,0 | 1,0 a 3,0 | 250 |
| 19 - 50 x 30 | 50 x 30 | 17 | 7,0 | 1,0 a 2,75 | 100 |
| 19 - 50 x 40 | 50 x 40 | 18 | 6,0 | 1,0 a 3,0 | 100 |
| 19 - 60 x 10 | 60 x 10 | 12 | 4,0 | 1,0 a 2,0 | 500 |
| 19 - 60 x 15 | 60 x 15 | 11 | 4,0 | 1,0 a 3,0 | 200 |
| 19 - 60 x 20 | 60 x 20 | 15 | 6,0 | 1,0 a 3,0 | 200 |
| 19 - 60 x 30 | 60 x 30 | 18 | 6,5 | 1,0 a 2,5 | 100 |
| 19 - 60 x 40 | 60 x 40 | 18 | 7,0 | 1,0 a 2,5 | 100 |
| 19 - 60 x 40 (3,0 a 5,0) | 60 x 40 | 18 | 7,0 | 3,0 a 5,0 | 100 |
| 19 - 70 x 20 | 70 x 20 | 15 | 6,0 | 1,0 a 2,5 | 200 |
| 19 - 70 x 30 | 70 x 30 | 18 | 6,0 | 1,0 a 2,5 | 100 |
| 19 - 70 x 30 (2,5 a 4,0) | 70 x 30 | 20 | 6,0 | 2,5 a 4,0 | 100 |
| 19 - 70 x 40 | 70 x 40 | 19 | 5,0 | 1,0 a 3,0 | 100 |
| 19 - 70 x 50 | 70 x 50 | 20 | 5,5 | 1,0 a 3,0 | 50 |
| 19 - 80 x 20 | 80 x 20 | 16 | 6,0 | 1,0 a 4,0 | 100 |
| 19 - 80 x 30 | 80 x 30 | 20 | 5,0 | 1,0 a 2,75 | 100 |
| 19 - 80 x 40 | 80 x 40 | 18 | 6,5 | 1,0 a 3,0 | 100 |
| 19 - 80 x 40 (3,0 a 5,0) | 80 x 40 | 18 | 6,5 | 3,0 a 5,0 | 100 |
| 19 - 80 x 50 | 80 x 50 | 19 | 6,0 | 1,0 a 2,5 | 50 |
| 19 - 80 x 60 | 80 x 60 | 19 | 6,0 | 1,0 a 3,5 | 50 |
| 19 - 90 x 40 | 90 x 40 | 19 | 6,0 | 1,0 a 2,5 | 50 |
| 19 - 90 x 40 (3,0 a 5,0) | 90 x 40 | 19 | 6,0 | 3,0 a 5,0 | 50 |
| 19 - 90 x 50 | 90 x 50 | 21,05 | 5,63 | 2,1 a 4,0 | 50 |
| 19 - 100 x 20 | 100 x 20 | 22 | 5,0 | 1,0 a 3,0 | 100 |
| 19 - 100 x 30 | 100 x 30 | 22 | 5,0 | 1,0 a 4,0 | 50 |
| 19 - 100 x 40 | 100 x 40 | 18 | 5,5 | 1,0 a 3,0 | 50 |
| 19 - 100 x 50 | 100 x 50 | 19 | 5,5 | 1,0 a 4,0 | 50 |
| 19 - 100 x 60 | 100 x 60 | 19 | 5,5 | 1,0 a 4,0 | 25 |
| 19 - 100 x 80 | 100 x 80 | 19 | 6,0 | 1,0 a 4,0 | 25 |
| 19 - 120 x 40 | 120 x 40 | 20 | 5,0 | 1,0 a 3,0 | 50 |
| 19 - 120 x 60 | 120 x 60 | 19 | 6,0 | 1,0 a 4,0 | 25 |
| 19 - 120 x 80 | 120 x 80 | 19 | 6,0 | 1,0 a 4,0 | 25 |
| 19 - 120 x 100 | 120 x 100 | 20 | 6,0 | 2,0 a 5,0 | 25 |
| 19 - 140 x 80 | 140 x 80 | 19 | 5,5 | 2,0 a 4,0 | 25 |
| 19 - 150 x 30 | 150 x 30 | 16 | 6,0 | 1,5 a 3,0 | 25 |
| 19 - 150 x 50 | 150 x 50 | 20 | 6,0 | 2,0 a 5,0 | 25 |
| 19 - 170 x 50 | 170 x 50 | 19 | 5,5 | 2,0 a 4,0 | 25 |

Ref. 27

Tapafinal rectangular interior estriado

Polietileno baja densidad
blanco o negro

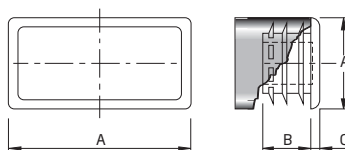

| REFERENCIA | A x A' | B | C | GROSOR TUBO | ENVASES |
|--------------|---------|----|------|-------------|---------|
| 27 - 20 x 10 | 20 x 10 | 10 | 3,00 | 1,0 a 2,5 | 1000 |
| 27 - 25 x 15 | 25 x 15 | 10 | 3,00 | 1,0 a 2,5 | 500 |
| 27 - 30 x 10 | 30 x 10 | 10 | 3,00 | 1,0 a 2,5 | 500 |
| 27 - 30 x 15 | 30 x 15 | 10 | 3,00 | 1,0 a 2,5 | 500 |
| 27 - 30 x 20 | 30 x 20 | 11 | 3,00 | 1,0 a 2,5 | 500 |
| 27 - 40 x 10 | 40 x 10 | 10 | 3,00 | 1,0 a 2,5 | 500 |
| 27 - 40 x 20 | 40 x 20 | 9 | 3,00 | 1,0 a 3,0 | 500 |
| 27 - 40 x 30 | 40 x 30 | 10 | 3,00 | 1,0 a 3,0 | 500 |
| 27 - 50 x 20 | 50 x 20 | 9 | 3,00 | 1,0 a 2,5 | 500 |
| 27 - 50 x 30 | 50 x 30 | 12 | 2,50 | 1,0 a 2,5 | 200 |
| 27 - 60 x 20 | 60 x 20 | 13 | 2,50 | 1,0 a 3,0 | 200 |
| 27 - 60 x 30 | 60 x 30 | 13 | 2,50 | 1,0 a 3,0 | 200 |
| 27 - 60 x 40 | 60 x 40 | 13 | 2,50 | 1,0 a 3,0 | 200 |
| 27 - 80 x 40 | 80 x 40 | 13 | 3,00 | 1,0 a 3,0 | 100 |

CALIDAD: NORMAS Y CERTIFICACIONES

FORTAPS cuenta desde 2003 con un Sistema de Calidad certificado por BUREAU VERITAS. Toda la actividad de FORTAPS (diseño, fabricación y comercialización) se realiza conforme a nuestro Manual de Calidad, basado en la norma ISO 9001:2015 de gestión de calidad.



Todos nuestros productos se fabrican en nuestras instalaciones bajo parámetros de producción y calidad estrictos, cumpliendo con las legislaciones vigentes (REACH, RoHS, etc).



Ref. 18

Contera rectangular ovalada interior estriada

Polietileno baja densidad
blanco o negro

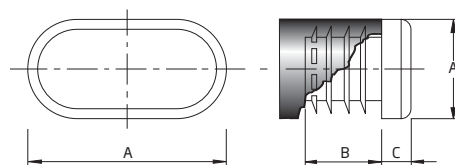

| REFERENCIA | A x A' | B | C | GROSOR TUBO | ENVASES |
|--------------|---------|----|-----|-------------|---------|
| 18 - 25 x 15 | 25 x 15 | 16 | 6,0 | 1,0 a 2,5 | 500 |
| 18 - 30 x 15 | 30 x 15 | 15 | 6,0 | 1,0 a 2,5 | 500 |
| 18 - 40 x 20 | 40 x 20 | 15 | 6,0 | 1,0 a 2,5 | 200 |
| 18 - 50 x 15 | 50 x 15 | 17 | 6,0 | 1,0 a 2,5 | 250 |
| 18 - 50 x 20 | 50 x 20 | 17 | 6,0 | 1,0 a 3,0 | 250 |
| 18 - 60 x 20 | 60 x 20 | 15 | 6,0 | 1,0 a 2,5 | 200 |
| 18 - 60 x 30 | 60 x 30 | 19 | 6,5 | 1,0 a 3,0 | 200 |

Ref. 23

Tapafinal ovalado interior estriado

Polietileno baja densidad
blanco o negro

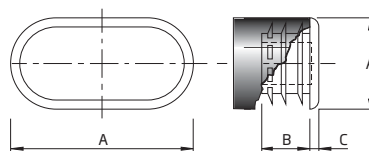

| REFERENCIA | A x A' | B | C | GROSOR TUBO | ENVASES |
|--------------|---------|----|-----|-------------|---------|
| 23 - 30 x 15 | 30 x 15 | 10 | 2,5 | 1,0 a 2,5 | 1000 |
| 23 - 40 x 20 | 40 x 20 | 10 | 2,5 | 1,0 a 2,5 | 500 |

Ref. 24

Tapafinal cuadrado interior estriado

Polietileno baja densidad
blanco o negro

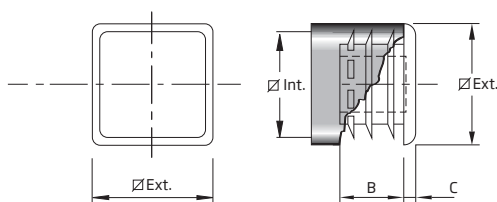

| REFERENCIA | $\varnothing Ext.$ | $\varnothing Int.$ | B | C | GROSOR TUBO | ENVASES |
|--------------|--------------------|--------------------|------|-----|-------------|---------|
| 24 - 16 x 16 | 16 | 11,5 a 14 | 9,0 | 2,0 | 1,0 a 2,25 | 1000 |
| 24 - 18 x 18 | 18 | 12,5 a 16 | 9,0 | 2,0 | 1,0 a 2,75 | 1000 |
| 24 - 20 x 20 | 20 | 14 a 18 | 9,0 | 2,0 | 1,0 a 3,0 | 1000 |
| 24 - 25 x 25 | 25 | 19 a 23 | 12,0 | 2,0 | 1,0 a 3,0 | 500 |
| 24 - 30 x 30 | 30 | 24 a 28 | 12,0 | 2,5 | 1,0 a 3,0 | 500 |
| 24 - 35 x 35 | 35 | 29 a 33 | 13,0 | 2,5 | 1,0 a 3,0 | 200 |
| 24 - 40 x 40 | 40 | 34 a 38 | 13,0 | 2,5 | 1,0 a 3,0 | 200 |
| 24 - 45 x 45 | 45 | 39 a 43 | 13,0 | 2,5 | 1,0 a 3,0 | 100 |
| 24 - 50 x 50 | 50 | 44 a 48 | 13,0 | 2,5 | 1,0 a 3,0 | 100 |
| 24 - 60 x 60 | 60 | 54 a 58 | 13,0 | 2,5 | 1,0 a 3,0 | 100 |

Ref. 15

Contera cuadrada interior estriada

Polietileno baja densidad
blanco o negro

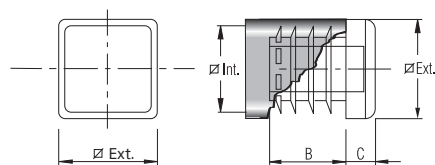

| REFERENCIA | ∅ Ext. | ∅ Int. | B | C | GROSOR TUBO | ENVASES |
|--------------------------|--------|---------|------|-----|-------------|---------|
| 15 - 12 x 12 | 12 | 7 a 10 | 14,0 | 4,5 | 1,0 a 2,5 | 1000 |
| 15 - 14 x 14 | 14 | 9 a 12 | 14,0 | 4,5 | 1,0 a 2,5 | 1000 |
| 15 - 16 x 16 | 16 | 11 a 14 | 15,5 | 5,5 | 1,0 a 2,5 | 500 |
| 15 - 18 x 18 | 18 | 13 a 16 | 15,5 | 5,5 | 1,0 a 2,5 | 500 |
| 15 - 20 x 20 | 20 | 14 a 18 | 17,0 | 6,0 | 1,0 a 3,0 | 500 |
| 15 - 22 x 22 | 22 | 17 a 20 | 19,5 | 5,0 | 1,0 a 2,5 | 500 |
| 15 - 25 x 25 | 25 | 19 a 23 | 20,0 | 6,0 | 1,0 a 3,0 | 200 |
| 15 - 30 x 30 | 30 | 24 a 28 | 20,0 | 6,0 | 1,0 a 3,0 | 200 |
| 15 - 35 x 35 | 35 | 29 a 33 | 20,0 | 6,0 | 1,0 a 3,0 | 200 |
| 15 - 40 x 40 | 40 | 34 a 38 | 18,0 | 6,5 | 1,0 a 3,0 | 100 |
| 15 - 40 x 40 (0,5 a 1,0) | 40 | 38 a 39 | 18,5 | 6,5 | 0,5 a 1,0 | 100 |
| 15 - 45 x 45 | 45 | 39 a 43 | 20,0 | 6,0 | 1,0 a 3,0 | 100 |
| 15 - 50 x 50 | 50 | 44 a 48 | 19,0 | 6,0 | 1,0 a 3,0 | 100 |
| 15 - 60 x 60 | 60 | 54 a 58 | 19,0 | 6,0 | 1,0 a 3,0 | 50 |

Ref. 26

Contera cuadrada interior estriada para tubos estructurales

Polietileno baja densidad
blanco o negro

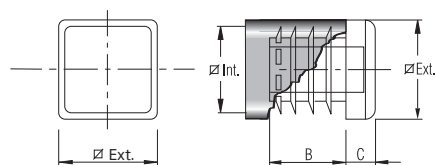

| REFERENCIA | ∅ Ext. | ∅ Int. | B | C | GROSOR TUBO | ENVASES |
|---------------------------|--------|-------------|------|-----|-------------|---------|
| 26 - 40 x 40 | 40 | 32 a 34 | 18,5 | 6,5 | 3,0 a 4,0 | 200 |
| 26 - 40 x 40 (4,5 a 5,5) | 40 | 29 a 31 | 18,0 | 6,9 | 4,5 a 5,5 | 100 |
| 26 - 40 x 40 (6,0 a 7,0) | 40 | 26 a 28 | 18,0 | 6,9 | 6,0 a 7,0 | 100 |
| 26 - 50 x 50 | 50 | 42,5 a 45,5 | 20,0 | 5,0 | 2,25 a 3,75 | 100 |
| 26 - 60 x 60 | 60 | 52 a 55 | 20,0 | 5,0 | 2,5 a 4,0 | 50 |
| 26 - 70 x 70 | 70 | 63 a 67 | 15,5 | 7,0 | 1,0 a 4,0 | 50 |
| 26 - 80 x 80 | 80 | 74 a 78 | 21,0 | 5,0 | 1,0 a 3,0 | 25 |
| 26 - 80 x 80 (3,25 a 5,0) | 80 | 70 a 73,5 | 21,0 | 5,0 | 3,25 a 5,0 | 25 |
| 26 - 90 x 90 | 90 | 82 a 88 | 19,0 | 6,0 | 1,0 a 4,0 | 25 |
| 26 - 100 x 100 | 100 | 92 a 98 | 19,0 | 6,0 | 1,0 a 4,0 | 25 |
| 26 - 110 x 110 | 110 | 102 a 106 | 21,0 | 6,0 | 2,0 a 4,0 | 10 |
| 26 - 120 x 120 | 120 | 112 a 116 | 20,5 | 6,0 | 2,0 a 4,0 | 10 |

Ref. 31

Contera cuadrada inclinada interior estriada

Polietileno baja densidad blanco o negro

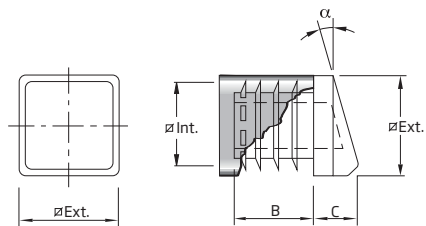

| REFERENCIA | $\varnothing Ext.$ | $\varnothing Int.$ | B | C | α | GROSOR TUBO | ENVASES |
|--------------|--------------------|--------------------|----|----|----------|-------------|---------|
| 31 - 20 x 20 | 20 | 15 a 18 | 19 | 9 | 20 | 1,0 a 2,5 | 500 |
| 31 - 22 x 22 | 22 | 17 a 20 | 19 | 10 | 20 | 1,0 a 2,5 | 500 |
| 31 - 25 x 25 | 25 | 20 a 23 | 19 | 10 | 15 | 1,0 a 2,5 | 500 |
| 31 - 30 x 30 | 30 | 25 a 28 | 19 | 10 | 20 | 1,0 a 2,5 | 200 |

Ref. 31 CAMAS

Contera cuadrada inclinada interior estriada

Polietileno baja densidad negro

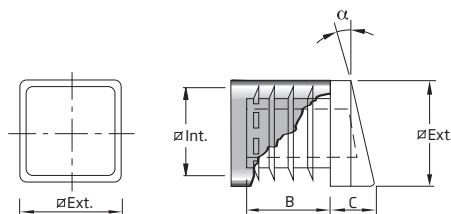

| REFERENCIA | $\varnothing Ext.$ | $\varnothing Int.$ | B | C | α | GROSOR TUBO | ENVASES |
|-----------------|--------------------|--------------------|----|----|----------|-------------|---------|
| 31 - 30 x 30 CA | 30 | 26 a 28 | 18 | 14 | 15 | 1,0 a 2,0 | 200 |

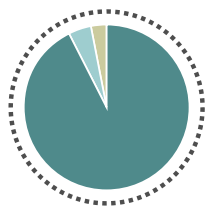

Expedición de pedidos:



90.13% pedidos servidos el mismo día.



95.72% pedidos servidos las primeras 24 hrs.

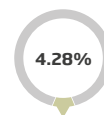

4.28% otros

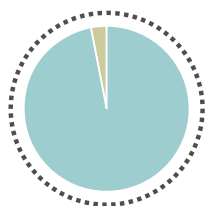

Stock permanente de 10.500.000 de piezas
 Todo pedido recibido antes de las 15:00h es expedido el mismo día
 Tracking: seguimiento y localización de envíos.

*FUENTE de datos; Auditoría ISO 9001:2015 Bureau Veritas (enero 2018)

Ref. 44

Tapafinal cuadrado
interior estriado
acabado en cromo brillo
Cromo mate bajo pedido

Material ABS

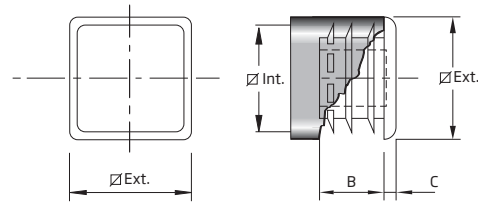

| REFERENCIA | Ø Ext. | B | C | GROSOR TUBO | ENVASES |
|--------------|--------|------|------|---------------------|---------|
| 44 - 20 x 20 | 20 | 8 | 2,25 | 0,8; 1,0; 1,5 y 2,0 | 500 |
| 44 - 25 x 25 | 25 | 8 | 2,25 | 1,0; 1,5 y 2,0 | 200 |
| 44 - 30 x 30 | 30 | 10,5 | 2,25 | 1,0; 1,5 y 2,0 | 200 |
| 44 - 35 x 35 | 35 | 10,5 | 2,25 | 1,0; 1,5 y 2,0 | 200 |
| 44 - 40 x 40 | 40 | 10,5 | 2,25 | 1,0; 1,5 y 2,0 | 200 |
| 44 - 50 x 50 | 50 | 10,5 | 2,25 | 1,0; 1,5 y 2,0 | 100 |

Ref. 47

Tapafinal cuadrado
interior estriado
acabado en brillo

Material ABS

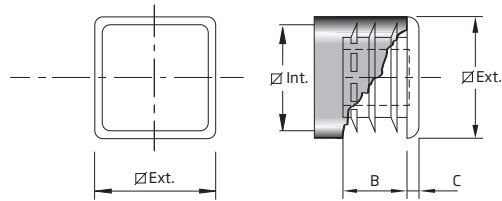

| REFERENCIA | Ø Ext. | B | C | GROSOR TUBO | ENVASES |
|--------------|--------|------|------|---------------------|---------|
| 47 - 20 x 20 | 20 | 8 | 2,25 | 0,8; 1,0; 1,5 y 2,0 | * |
| 47 - 25 x 25 | 25 | 8 | 2,25 | 1,0; 1,5 y 2,0 | * |
| 47 - 30 x 30 | 30 | 10,5 | 2,25 | 1,0; 1,5 y 2,0 | * |
| 47 - 35 x 35 | 35 | 10,5 | 2,25 | 1,0; 1,5 y 2,0 | * |
| 47 - 40 x 40 | 40 | 10,5 | 2,25 | 1,0; 1,5 y 2,0 | * |
| 47 - 50 x 50 | 50 | 10,5 | 2,25 | 1,0; 1,5 y 2,0 | * |

consultar la disponibilidad de colores

* Consultar

ÁREA DE DESCARGA en www.fortaps.com

- * Códigos EAN-13 de todas nuestras referencias
- * Listados de referencias
- * Certificados de calidad
- * Declaraciones de conformidad de normativas vigentes



Ref. 34

Contera cuadrada interior roscada

Polietileno alta densidad negro
Carga máxima estática: 70 Kg por pie

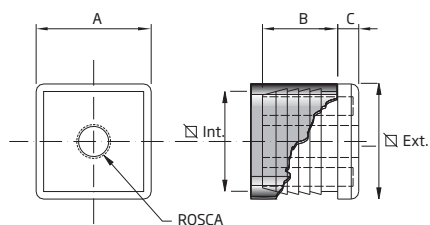

| REFERENCIA | ROSCA | GROSOR TUBO | Ø Ext. | Ø Int. | B | C | ENVASES |
|----------------|-------|-------------|--------|-------------|----|-----|---------|
| 34 - 20 x 20/1 | M8 | 1,0 a 1,5 | 20 | 17,2 a 18,0 | 20 | 5,5 | 500 |
| 34 - 20 x 20/2 | M8 | 1,6 a 2,0 | 20 | 16,0 a 17,0 | 20 | 5,5 | 500 |
| 34 - 22 x 22/1 | M8 | 1,0 a 1,5 | 22 | 19,2 a 20,0 | 20 | 5,5 | 500 |
| 34 - 22 x 22/2 | M8 | 1,6 a 2,0 | 22 | 18,0 a 19,0 | 20 | 5,5 | 500 |
| 34 - 25 x 25/1 | M8 | 1,0 a 1,5 | 25 | 22,2 a 23,0 | 20 | 5,5 | 200 |
| 34 - 25 x 25/2 | M8 | 1,6 a 2,0 | 25 | 21,0 a 22,0 | 20 | 5,5 | 200 |
| 34 - 25 x 25/3 | M10 | 1,0 a 1,5 | 25 | 22,2 a 23,0 | 20 | 5,5 | 200 |
| 34 - 25 x 25/4 | M10 | 1,6 a 2,0 | 25 | 21,0 a 22,0 | 20 | 5,5 | 200 |
| 34 - 30 x 30/1 | M8 | 1,0 a 1,5 | 30 | 27,2 a 28,0 | 20 | 5,5 | 200 |
| 34 - 30 x 30/2 | M8 | 1,6 a 2,0 | 30 | 26,0 a 27,0 | 20 | 5,5 | 200 |
| 34 - 30 x 30/3 | M10 | 1,0 a 1,5 | 30 | 27,2 a 28,0 | 20 | 5,5 | 200 |
| 34 - 30 x 30/4 | M10 | 1,6 a 2,0 | 30 | 26,0 a 27,0 | 20 | 5,5 | 200 |
| 34 - 35 x 35/1 | M8 | 1,0 a 1,5 | 35 | 32,2 a 33,0 | 20 | 5,5 | 200 |
| 34 - 35 x 35/2 | M8 | 1,6 a 2,0 | 35 | 31,0 a 32,0 | 20 | 5,5 | 200 |
| 34 - 35 x 35/3 | M10 | 1,0 a 1,5 | 35 | 32,2 a 33,0 | 20 | 5,5 | 200 |
| 34 - 35 x 35/4 | M10 | 1,6 a 2,0 | 35 | 31,0 a 32,0 | 20 | 5,5 | 200 |
| 34 - 40 x 40/1 | M8 | 1,0 a 1,5 | 40 | 37,2 a 38,0 | 20 | 5,5 | 100 |
| 34 - 40 x 40/2 | M8 | 1,6 a 2,0 | 40 | 36,0 a 37,0 | 20 | 5,5 | 100 |
| 34 - 40 x 40/3 | M10 | 1,0 a 1,5 | 40 | 37,2 a 38,0 | 20 | 5,5 | 100 |
| 34 - 40 x 40/4 | M10 | 1,6 a 2,0 | 40 | 36,0 a 37,0 | 20 | 5,5 | 100 |
| 34 - 45 x 45/1 | M10 | 1,0 a 1,5 | 45 | 42,2 a 43,0 | 20 | 5,5 | 100 |
| 34 - 45 x 45/2 | M10 | 1,6 a 2,0 | 45 | 41,0 a 42,0 | 20 | 5,5 | 100 |
| 34 - 50 x 50/1 | M8 | 1,0 a 1,5 | 50 | 47,2 a 48,0 | 20 | 5,5 | 100 |
| 34 - 50 x 50/2 | M8 | 1,6 a 2,0 | 50 | 46,0 a 47,0 | 20 | 5,5 | 100 |
| 34 - 50 x 50/3 | M10 | 1,0 a 1,5 | 50 | 47,2 a 48,0 | 20 | 5,5 | 100 |
| 34 - 50 x 50/4 | M10 | 1,6 a 2,0 | 50 | 46,0 a 47,0 | 20 | 5,5 | 100 |
| 34 - 60 x 60/1 | M8 | 1,0 a 1,5 | 60 | 57,2 a 58,0 | 20 | 5,5 | 50 |
| 34 - 60 x 60/2 | M8 | 1,6 a 2,0 | 60 | 56,0 a 57,0 | 20 | 5,5 | 50 |
| 34 - 60 x 60/3 | M10 | 1,0 a 1,5 | 60 | 57,2 a 58,0 | 20 | 5,5 | 50 |
| 34 - 60 x 60/4 | M10 | 1,6 a 2,0 | 60 | 56,0 a 57,0 | 20 | 5,5 | 50 |

Ref. 35

Contera redonda interior roscada

Polietileno alta densidad negro
Carga máxima estática: 70 Kg por pie

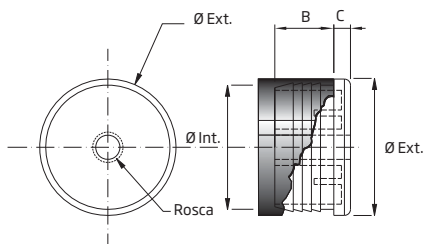

| REFERENCIA | ROSCA | GROSOR TUBO | Ø Ext. | Ø Int. | B | C | ENVASES |
|------------|-------|-------------|--------|-------------|----|-----|---------|
| 35 - 20/1 | M8 | 1,0 a 1,5 | 20 | 17,2 a 18,0 | 20 | 5,5 | 500 |
| 35 - 20/2 | M8 | 1,6 a 2,0 | 20 | 16,0 a 17,0 | 20 | 5,5 | 500 |
| 35 - 22/1 | M8 | 1,0 a 1,5 | 22 | 19,2 a 20,0 | 20 | 5,5 | 500 |
| 35 - 22/2 | M8 | 1,6 a 2,0 | 22 | 18,0 a 19,0 | 20 | 5,5 | 500 |
| 35 - 25/1 | M8 | 1,0 a 1,5 | 25 | 22,2 a 23,0 | 20 | 5,5 | 500 |
| 35 - 25/2 | M8 | 1,6 a 2,0 | 25 | 21,0 a 22,0 | 20 | 5,5 | 500 |
| 35 - 25/3 | M10 | 1,0 a 1,5 | 25 | 22,2 a 23,0 | 20 | 5,5 | 500 |
| 35 - 25/4 | M10 | 1,6 a 2,0 | 25 | 21,0 a 22,0 | 20 | 5,5 | 500 |
| 35 - 30/1 | M8 | 1,0 a 1,5 | 30 | 27,2 a 28,0 | 20 | 5,5 | 200 |
| 35 - 30/2 | M8 | 1,6 a 2,0 | 30 | 26,0 a 27,0 | 20 | 5,5 | 200 |
| 35 - 30/3 | M10 | 1,0 a 1,5 | 30 | 27,2 a 28,0 | 20 | 5,5 | 200 |
| 35 - 30/4 | M10 | 1,6 a 2,0 | 30 | 26,0 a 27,0 | 20 | 5,5 | 200 |
| 35 - 32/1 | M8 | 1,0 a 1,5 | 32 | 29,0 a 30,0 | 20 | 5,0 | 200 |
| 35 - 32/2 | M8 | 1,6 a 2,0 | 32 | 28,0 a 29,0 | 20 | 5,0 | 200 |
| 35 - 32/3 | M10 | 1,0 a 1,5 | 32 | 29,0 a 30,0 | 20 | 5,0 | 200 |
| 35 - 32/4 | M10 | 1,6 a 2,0 | 32 | 28,0 a 29,0 | 20 | 5,0 | 200 |
| 35 - 35/1 | M8 | 1,0 a 1,5 | 35 | 32,2 a 33,0 | 20 | 5,5 | 200 |
| 35 - 35/2 | M8 | 1,6 a 2,0 | 35 | 31,0 a 32,0 | 20 | 5,5 | 200 |
| 35 - 35/3 | M10 | 1,0 a 1,5 | 35 | 32,2 a 33,0 | 20 | 5,5 | 200 |
| 35 - 35/4 | M10 | 1,6 a 2,0 | 35 | 31,0 a 32,0 | 20 | 5,5 | 200 |
| 35 - 40/1 | M8 | 1,0 a 1,5 | 40 | 37,2 a 38,0 | 20 | 5,5 | 100 |
| 35 - 40/2 | M8 | 1,6 a 2,0 | 40 | 36,0 a 37,0 | 20 | 5,5 | 100 |
| 35 - 40/3 | M10 | 1,0 a 1,5 | 40 | 37,2 a 38,0 | 20 | 5,5 | 100 |
| 35 - 40/4 | M10 | 1,6 a 2,0 | 40 | 36,0 a 37,0 | 20 | 5,5 | 100 |
| 35 - 45/1 | M10 | 1,0 a 1,5 | 45 | 42,2 a 43,0 | 20 | 5,5 | 100 |
| 35 - 45/2 | M10 | 1,6 a 2,0 | 45 | 41,0 a 42,0 | 20 | 5,5 | 100 |
| 35 - 50/1 | M10 | 1,0 a 1,5 | 50 | 47,2 a 48,0 | 20 | 5,5 | 100 |
| 35 - 50/2 | M10 | 1,6 a 2,0 | 50 | 46,0 a 47,0 | 20 | 5,5 | 100 |
| 35 - 60/1 | M10 | 1,0 a 1,5 | 60 | 57,2 a 58,0 | 20 | 5,5 | 100 |
| 35 - 60/2 | M10 | 1,6 a 2,0 | 60 | 56,0 a 57,0 | 20 | 5,5 | 100 |

Ref. 56

Contera interior roscada

Poliétileno alta densidad negro
Carga máxima estática: 70 Kg por pie

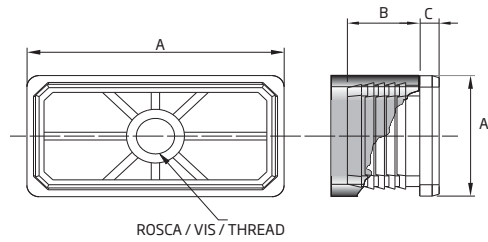

| REFERENCIA | ROSCA | AxA' | GROSOR TUBO | B | C | ENVASES |
|----------------|-------|---------|-------------|------|-----|---------|
| 56 - 40 x 20/2 | M8 | 40 x 20 | 1,5 a 2,0 | 20,5 | 5,5 | 200 |
| 56 - 50 x 20/2 | M8 | 50 x 20 | 1,5 a 2,0 | 20,5 | 5,5 | 200 |
| 56 - 60 x 30/4 | M10 | 60 x 30 | 1,5 a 2,0 | 20,5 | 5,5 | 100 |
| 56 - 60 x 40/3 | M10 | 60 x 40 | 1,0 a 1,5 | 19,8 | 5,3 | 100 |
| 56 - 60 x 40/4 | M10 | 60 x 40 | 1,6 a 2,0 | 19,8 | 5,3 | 100 |

EMPRESA
CATÁLOGO
COLORES
SOLUCIONES A MEDIDA
CALIDAD Y COMPROMISO
PEDIDOS Y CONSULTAS
NOVEDADES

CUADRADAS

REDONDAS

RECTANGULARES

ÓVALES

EXTERIORES

PIES NIVELADORES

ESPECIALES

Ref. 16
CONTERA INTERIOR ESTRIADA

Ref. 20
CONTERA RECTANGULAR INTERIOR ESTRIADA

Ref. 20
CONTERA OVALADA INTERIOR ESTRIADA

Ref. 20
CONTERA RECTANGULAR INTERIOR FLUJADA

Ref. 25
CONTERA INTERIOR REDONDA

Ref. 27
TAPAJRAL INTERIOR ESTRIADA

Ref. 28
TAPAJRAL INTERIOR ESTRIADA (CON 4445)

Ref. 37
TAPAJRAL INTERIOR ESTRIADA (CON 4445)

[Recomendar este producto](#)

Ref. 16

CONTERA INTERIOR ESTRIADA

Poliétileno de baja densidad, (PELD)

Colores estándar: blanco y negro

| Referencia | Ø Ext. | Ø Int. | B | C | GROSOR TUBO | ENVASES | Ref. 30 | igs | Ficha de Producto | Presupuesto | Muestras |
|------------|--------|---------|------|-----|-------------|---------|---------|-----|-------------------|-------------|----------|
| 16-12 | 12 | 6-10 | 12 | 5,5 | 1,0-2,0 | 1000 | | | | | |
| 16-14 | 14 | 10-12 | 12 | 5,5 | 1,0-2,0 | 1000 | | | | | |
| 16-18/2 | 18 | 18,2-24 | 15,5 | 8,5 | 1,0-1,4 | 500 | | | | | |
| 16-16/2 | 16 | 12-13 | 15,5 | 6,5 | 1,5-2,0 | 500 | | | | | |
| 16-20 | 18 | 14-20 | 16,5 | 8 | 1,0-2,0 | 1000 | | | | | |



www.fortaps.com

Pdf 3D

igs

Ficha de Producto

Presupuesto

Muestras

PIES NIVELADORES

A completar con las conteras perforadas para tubos cuadrados, redondos y rectangulares
(Refs. 34, 35 y 56)

Ref. 53

Base con rótula

Eje en Poliamida (PA6.6)
Base en Polietileno de Alta Densidad (PEHD)
Carga máxima estática: 150 Kg por pie

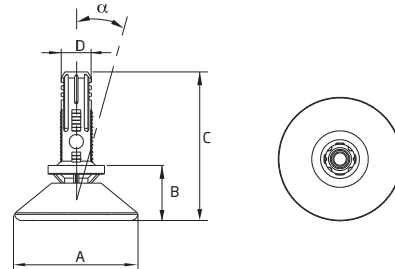

| REFERENCIA | A | B | C | α | D | ENVASES |
|------------|----|------|------|----------|-----|---------|
| 53 - 32 | 32 | 15,6 | 42,2 | 15° | 8,5 | 200 |
| 53 - 40 | 40 | 15,6 | 42,2 | 15° | 8,5 | 200 |
| 53 - 50 | 32 | 15,6 | 42,2 | 15° | 8,5 | 200 |

Ref. 55

Pie nivelador con rótula

Eje en Poliamida (PA6.6)
Base en Polietileno de Alta Densidad (PEHD)
Carga máxima estática: 150 Kg por pie

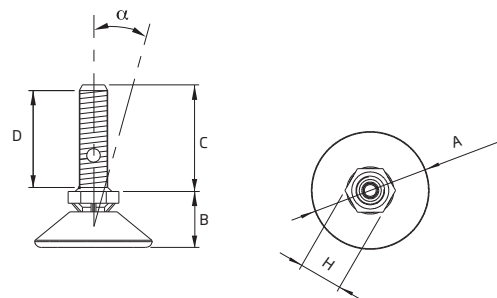

| REFERENCIA | A | B | C | α | ROSCA | D | H | ENVASES |
|------------|----|------|------|----------|-------|----|----|---------|
| 55 - 32 | 32 | 16,6 | 31,8 | 15° | M10 | 28 | 13 | 100 |
| 55 - 40 | 40 | 19,4 | 31,8 | 15° | M10 | 28 | 13 | 100 |
| 55 - 50 | 50 | 19,5 | 31,8 | 15° | M10 | 28 | 13 | 100 |

Ref. 58

Pie nivelador de perfil bajo

Eje en Poliamida (PA6.6)
Base en Polietileno de Alta Densidad (PEHD)
Carga máxima estática: 150 Kg por pie

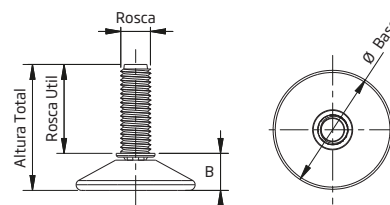

| REFERENCIA | ROSCA | Ø Base | ALTURA TOTAL | ROSCA UTIL | UNIDADES |
|------------|-------|--------|--------------|------------|----------|
| 58 - 32 | M10 | 32 | 42,5 | 30 | 100 |
| 58 - 40 | M10 | 40 | 42,5 | 30 | 100 |
| 58 - 50 | M10 | 50 | 42,5 | 30 | 100 |

Ref. 45

Pie nivelador

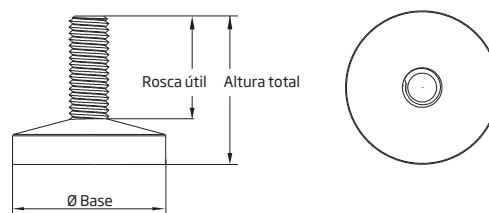

| REFERENCIA | ROSCA | Ø Base | ALTURA TOTAL | ROSCA UTIL | UNIDADES |
|------------|-------|--------|--------------|------------|----------|
| 45 - 30 | M8 | 32 | 30 | 20 | 100 |
| 45 - 40 | M8 | 40 | 38 | 20 | 100 |
| 45 - 30 | M10 | 30 | 47 | 32 | 100 |
| 45 - 40 | M10 | 40 | 47 | 29 | 100 |
| 45 - 50 | M10 | 50 | 45 | 30 | 50 |

20 Años de actividad



591.960.668

Piezas vendidas



Pedidos servidos

127.618

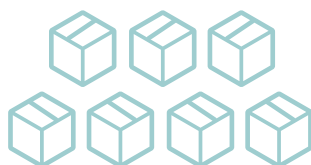

7.900

Clientes



Países

**ESPAÑA, FRANCIA, REINO UNIDO,
ALEMANIA, ESTADOS UNIDOS...**



Ref. 50

Contera redonda exterior reforzada

Caucho vulcanizado
Colores estándar: blanco y negro

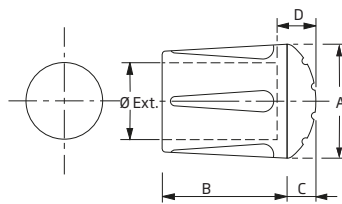

| REFERENCIA | Ø Ext tubo. | A | B | C | D | ENVASES |
|------------|-------------|------|----|------|---|---------|
| 50 - 8 | 8 a 9 | 20,5 | 21 | 3 | 6 | 100 |
| 50 - 10 | 10 a 11 | 20,5 | 21 | 3 | 6 | 100 |
| 50 - 12 | 12 a 13 | 25 | 23 | 3,25 | 6 | 100 |
| 50 - 14 | 14 a 15 | 25 | 25 | 3,5 | 6 | 100 |
| 50 - 16 | 16 a 17 | 27,5 | 26 | 3,8 | 6 | 100 |
| 50 - 18 | 18 a 19 | 30 | 28 | 3,8 | 6 | 100 |
| 50 - 20 | 20 a 21 | 32 | 30 | 5 | 7 | 100 |
| 50 - 22 | 22 a 23 | 34 | 31 | 5 | 7 | 100 |
| 50 - 25 | 25 a 26 | 37 | 31 | 5 | 7 | 100 |
| 50 - 28 | 28 a 29 | 43 | 34 | 5,75 | 8 | 50 |
| 50 - 30 | 30 a 31 | 43 | 34 | 5,75 | 8 | 50 |
| 50 - 32 | 32 a 33 | 48 | 35 | 6,5 | 8 | 50 |
| 50 - 35 | 35 a 36 | 48 | 35 | 6,5 | 8 | 50 |
| 50 - 38 | 38 a 39 | 53 | 35 | 6,5 | 8 | 50 |
| 50 - 40 | 40 a 42 | 53 | 35 | 6,5 | 8 | 50 |

Ref. 40

Contera redonda exterior flexible

Caucho termoplástico
blanco o negro

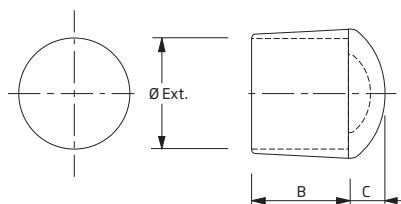

| REFERENCIA | Ø Ext. Tubo | B | C | ENVASES |
|------------|-------------|------|-------|---------|
| 40 - 3 | 3 | 7,8 | 0,9 | 5000 |
| 40 - 4 | 4 | 9,0 | 1,25 | 2500 |
| 40 - 5 | 5 | 9,25 | 1,75 | 2500 |
| 40 - 6 | 6 | 10,0 | 1,75 | 2500 |
| 40 - 7 | 7 | 11,0 | 1,75 | 2500 |
| 40 - 8 | 8 | 12,0 | 3,0 | 1000 |
| 40 - 10 | 10 | 14,0 | 3,26 | 1000 |
| 40 - 12 | 12 | 16,0 | 3,64 | 1000 |
| 40 - 14 | 14 | 17,0 | 4,0 | 1000 |
| 40 - 16 | 16 | 18,0 | 4,50 | 1000 |
| 40 - 18 | 18 | 19,0 | 5,0 | 500 |
| 40 - 20 | 20 | 20,0 | 5,25 | 500 |
| 40 - 22 | 22 | 22,0 | 5,50 | 500 |
| 40 - 25 | 25 | 23,0 | 6,0 | 200 |
| 40 - 28 | 28 | 24,0 | 6,50 | 200 |
| 40 - 30 | 30 | 25,0 | 7,0 | 200 |
| 40 - 32 | 32 | 26,0 | 8,0 | 200 |
| 40 - 35 | 35 | 28,0 | 9,0 | 100 |
| 40 - 38 | 38 | 29,0 | 9,50 | 100 |
| 40 - 40 | 40 | 30,0 | 10,0 | 100 |
| 40 - 42 | 42 | 30,0 | 10,25 | 100 |
| 40 - 45 | 45 | 30,0 | 10,50 | 50 |
| 40 - 48 | 48 | 30,0 | 11,0 | 50 |
| 40 - 50 | 50 | 30,0 | 12,0 | 50 |
| 40 - 60 | 60 | 30,0 | 14,0 | 25 |

Ref. 41

Conteras exteriores

Polietileno baja densidad negro

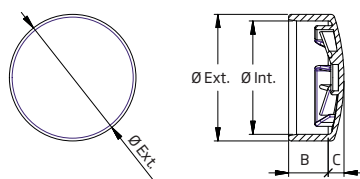

Redonda

| REFERENCIA | Ø Ext. | Ø Int. | B | C | ENVASES |
|------------|--------|--------|----|-----|---------|
| 41 - 42 | 48 | 42 | 16 | 5,0 | 100 |
| 41 - 45 | 53 | 45 | 15 | 4,0 | 100 |
| 41 - 48 | 54 | 48 | 16 | 5,0 | 100 |

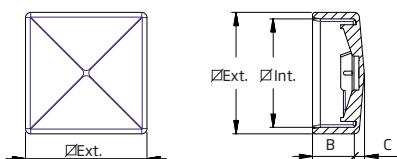

Cuadrada

| REFERENCIA | Ø Ext. | Ø Int. | B | C | ENVASES |
|--------------|---------|---------|----|-----|---------|
| 41 - 40 x 40 | 46 x 46 | 40 x 40 | 16 | 4,0 | 100 |
| 41 - 60 x 60 | 66 x 66 | 60 x 60 | 16 | 4,0 | 50 |

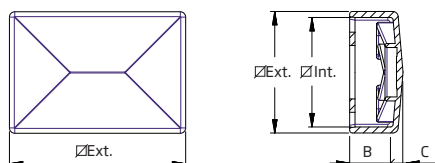

Rectangular

| REFERENCIA | Ø Ext. | Ø Int. | B | C | ENVASES |
|--------------|---------|---------|----|-----|---------|
| 41 - 40 x 60 | 44 x 64 | 40 x 60 | 15 | 4,5 | 100 |

Ref. 48

Tapa tuerca

Polietileno baja densidad blanco, negro y gris (RAL 7040)

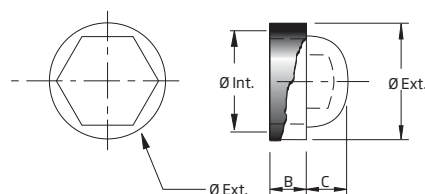

| REFERENCIA | Ø Ext. | B | C | HEXAGONAL | ENVASES |
|------------|--------|------|------|-----------|---------|
| 48 - M6 | 14 | 7,5 | 5,5 | 10 | 1000 |
| 48 - M8 | 18 | 9,0 | 6,0 | 13 | 500 |
| 48 - M10 | 22 | 10,0 | 6,0 | 17 | 200 |
| 48 - M12 | 24 | 12,0 | 8,5 | 19 | 200 |
| 48 - M14 | 28 | 14,0 | 7,3 | 22 | 200 |
| 48 - M16 | 30,5 | 15,3 | 7,9 | 24 | 200 |
| 48 - M18 | 34,5 | 17,2 | 12,0 | 27 | 100 |
| 48 - M20 | 38,2 | 19,0 | 13,0 | 30 | 100 |

Ref. 43

Contera redonda exterior
para bastones con
arandela metálica

Caucho vulcanizado

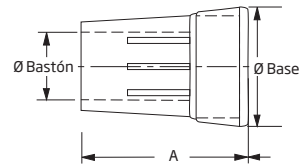

| REFERENCIA | Ø Bastón | Ø Base | A | ENVASES |
|------------|----------|--------|----|---------|
| 43 - 18 | 18 | 40 | 56 | 50 |

Gama complementaria

Rueda

Ø 32
Ancho = 16
Ø eje = 5,50



Ruleta

Ø 29
Ancho = 12
Ø eje = 4
Canal = 8



Topes presión

10 x 5



Contera horizontal o brida

25 - 30
Ø 30



Contera cuadrada para inserto

50 x 50
Ø 23

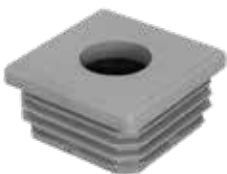

Contera oval base plana

40 x 20



Patin

Blanco / Negro
67,5 x 12,5



Asiento de taburete

Ø ext 310x4
Ø int 3,50



Ref. 59

Pie de media caña para tubo horizontal

Poliétileno de baja densidad, (PELD)
Color estándar: negro

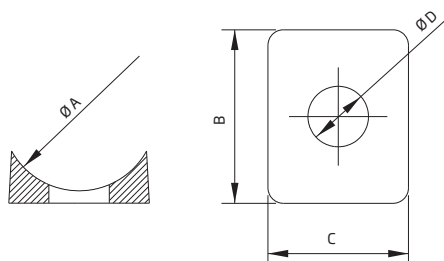

| REFERENCIA | A | B | C | D | ENVASES |
|------------|-------|------|------|-----|---------|
| 59 - 20/22 | 20/22 | 22,5 | 18,0 | 7,5 | 1000 |
| 59 - 25 | 25 | 32,5 | 25,5 | 7,5 | 500 |

Ref. 60

Tope atornillable

Poliétileno de baja densidad, (PELD)
Color estándar: negro

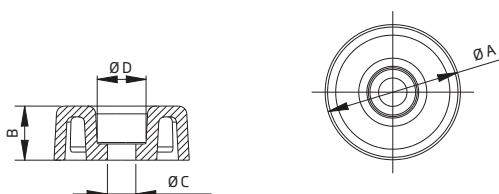

| REFERENCIA | A | B | C | D | ENVASES |
|------------|----|------|------|------|---------|
| 60 - 15 | 15 | 6,0 | 3,0 | 6,0 | 1000 |
| 60 - 20 | 20 | 8,0 | 3,5 | 8,0 | 1000 |
| 60 - 25 | 25 | 10,0 | 5,25 | 9,0 | 1000 |
| 60 - 30 | 30 | 12,0 | 6,25 | 14,0 | 500 |
| 60 - 40 | 40 | 14,0 | 6,25 | 18,0 | 200 |

Ref. 57

Contera para tubo horizontal (Brida)

Poliétileno de baja densidad, (PELD)
Color estándar: negro

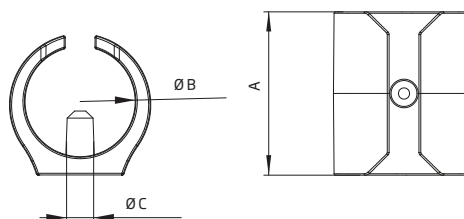

| REFERENCIA | A | B | C | ENVASES |
|------------|----|------|-----|---------|
| 57 - 14 | 23 | 14,0 | 4,0 | 1000 |
| 57 - 16 | 23 | 16,0 | 4,0 | 1000 |
| 57 - 18 | 23 | 18,0 | 5,0 | 500 |
| 57 - 20 | 23 | 20,0 | 5,0 | 500 |
| 57 - 22 | 23 | 22,0 | 5,0 | 250 |
| 57 - 25 | 23 | 25,0 | 5,0 | 250 |
| 57 - 30 | 23 | 30,0 | 5,0 | 250 |

Ref. 32

Topes tipo chincheta

Polietileno baja densidad
blanco o negro

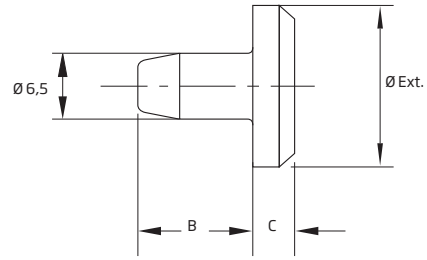

| REFERENCIA | $\varnothing \text{Ext.}$ | B | C | ENVASES |
|------------|---------------------------|----|---|---------|
| 32 - 16 | 16 | 11 | 4 | 1000 |

Ref. 33

Topes tipo chincheta para tubos redondos

Polietileno baja densidad
blanco o negro

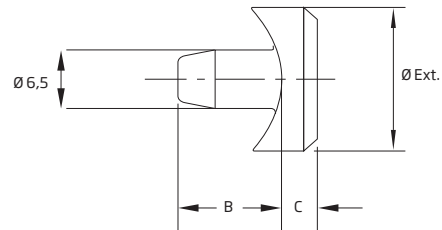

| REFERENCIA | $\varnothing \text{Ext.}$ | B | C | ENVASES |
|--------------|---------------------------|----|---|---------|
| 33 - 18 - 25 | 16 | 11 | 4 | 1000 |

Ref. 10

Tope redondo semiesférico

Polietileno baja densidad
blanco o negro

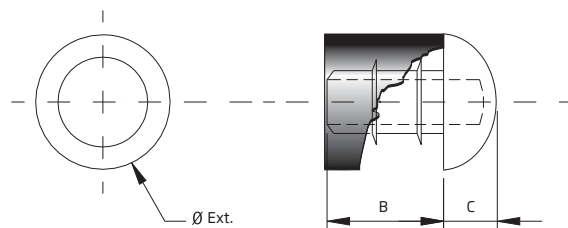

| REFERENCIA | $\varnothing \text{Ext.}$ | B | C | ENVASES |
|------------|---------------------------|------|-----|---------|
| 10 - 16 | 15,50 | 12,0 | 6,0 | 1000 |

Para agujero de 7,5 a 9,0 mm de \varnothing

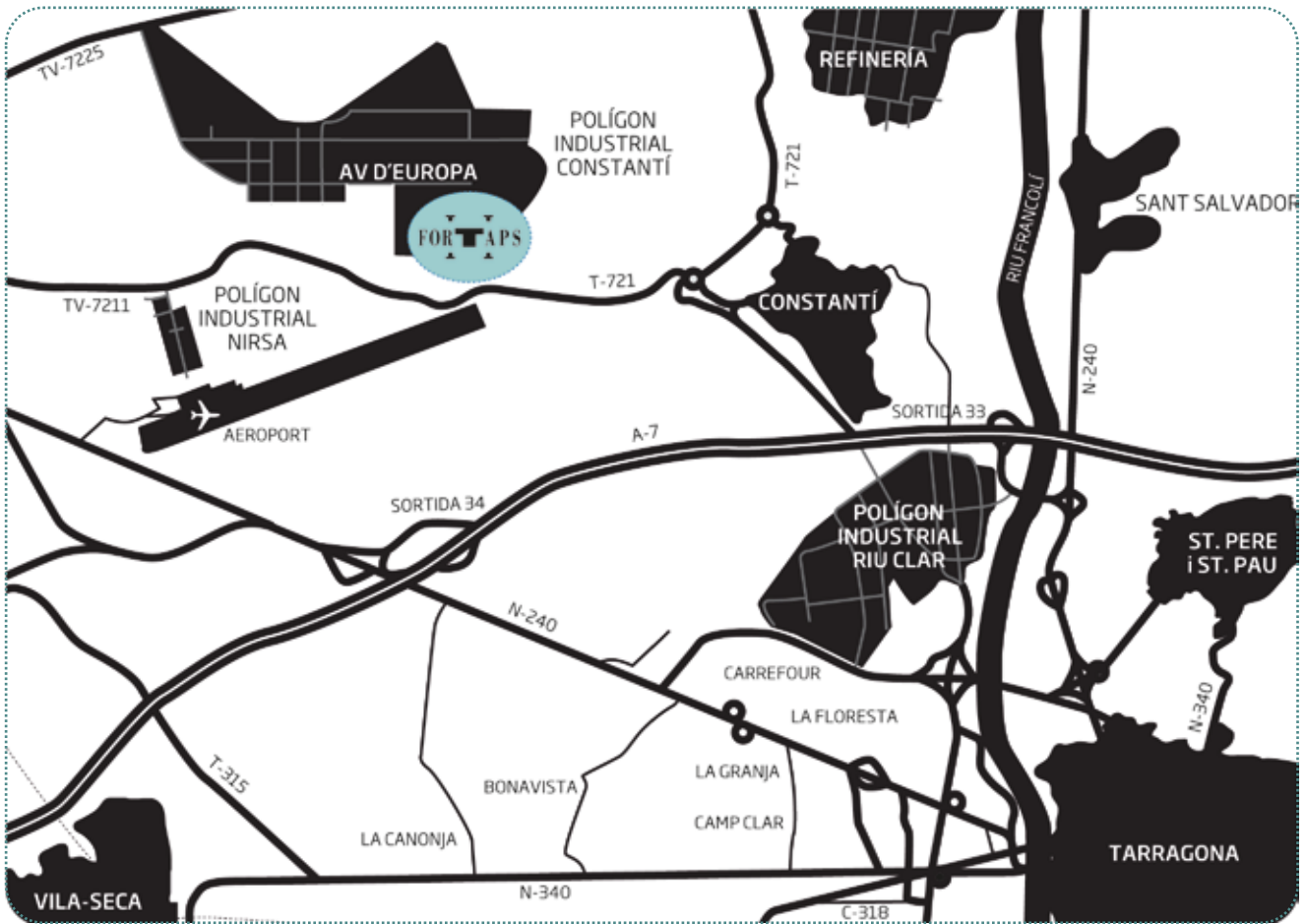

Coordenadas GPS: Latitud:41° 09' 21,90" N · Longitud:1° 10' 41,90" E

C. Reino Unido, 12-13 · Pol. Ind. de Constantí-Fase II · 43120 CONSTANTÍ (Tarragona)
Tel. 902 364 083 · Fax 902 364 084 · www.fortaps.com · fortaps@fortaps.com



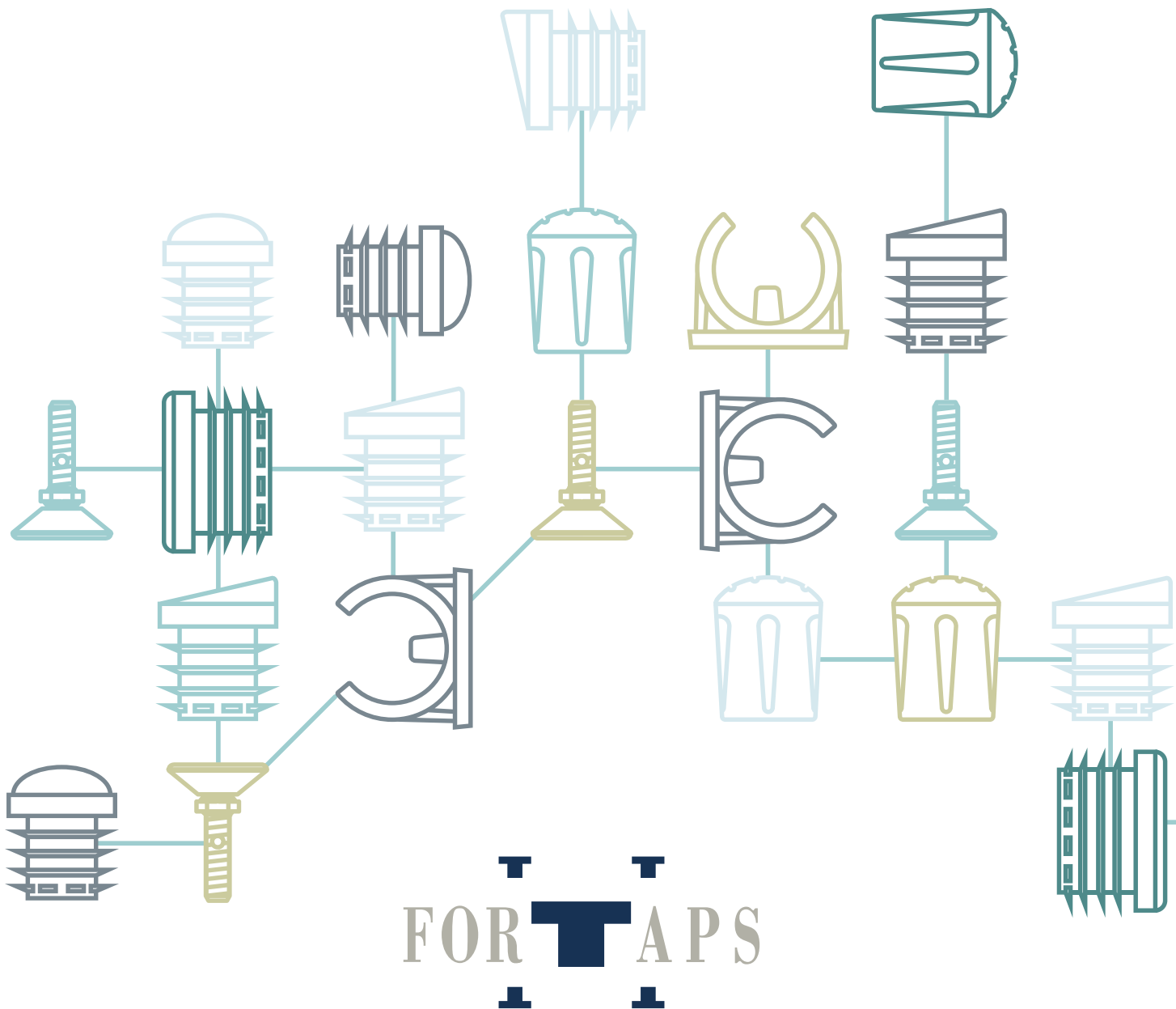

FOR TAPS

C. REINO UNIDO, 12-13
POL. IND. DE CONSTANTÍ-FASE II
43120 CONSTANTÍ (TARRAGONA)
TEL. 902 364 083
FAX 902 364 084

